

CM Lodestar Electric Chain Hoist Mechanical Parts List

SEPARATELY

** WITH LATCH TYPE HOOK. IF LOWER HOOK BLOCK ASSEMBLY WITH LATCHLOK TYPE HOOK IS REQUIRED, CONTACT CM.

*** CONTACT CM FOR PART NUMBER OF LATCHLOK TYPE HOOK.

Assemble Nut
Against
Bearing
As Shown

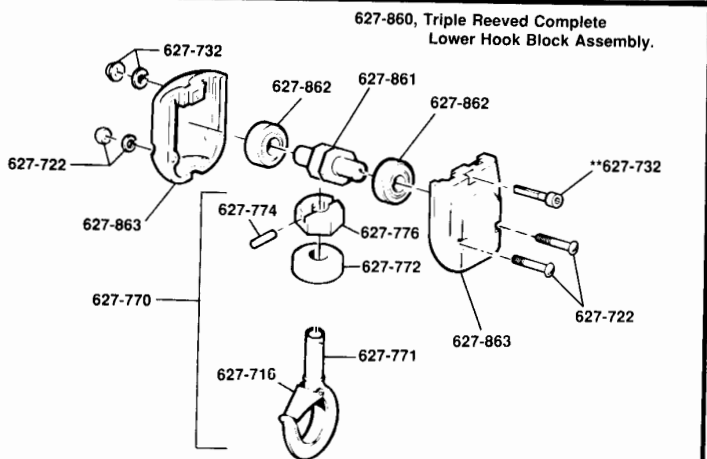
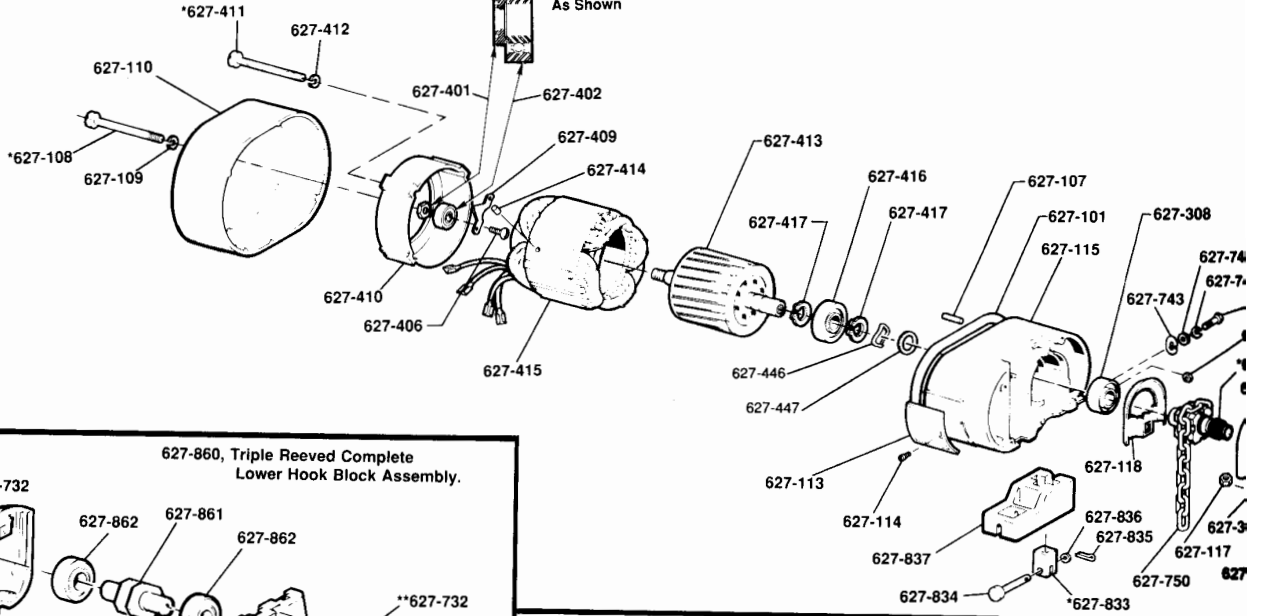

**When removing or installing
dead end screw, refer to step j
on page 30

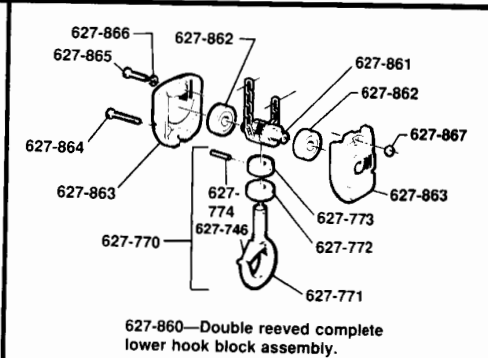
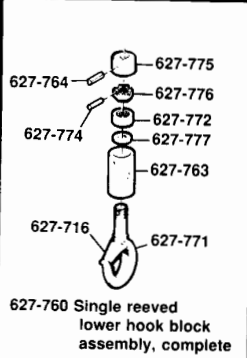

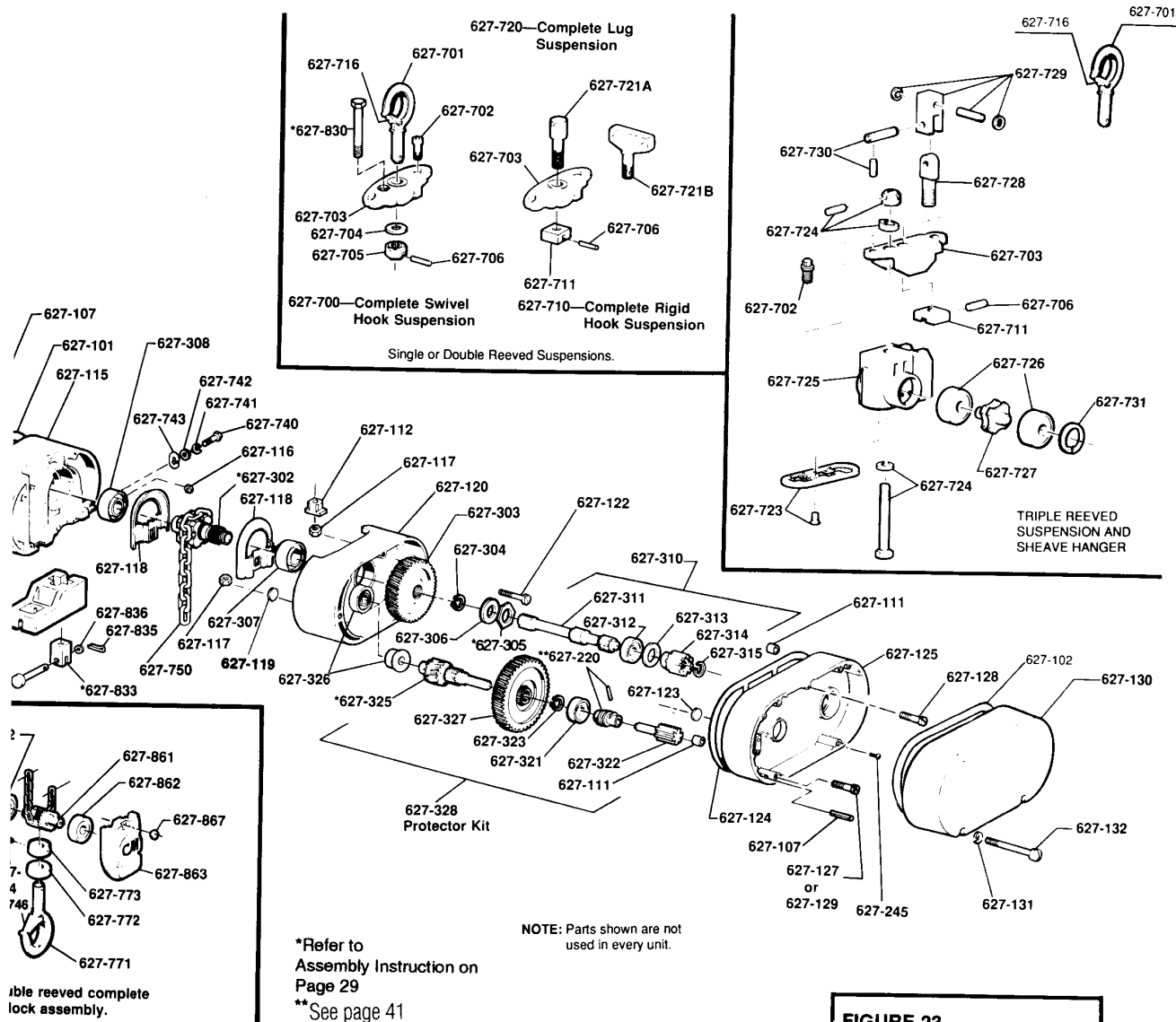

FIGURE 23
Exploded View-Mechanical
Components.
Lodestar Electric Chain
Hoists Model A thru RRT-2

Key No.	Part Name	No. Req'd	Models				
			A, A-2, AA, AA-2, B, B-2, C, C-2, F, F-2	E, E-2, H, H-2	J, J-2, JJ, JJ-2, L, L-2, LL, LL-2	R, R-2, RR, RR-2	RT, RT-2, RRT, RRT-2
			Part Number				
627-101	Motor Housing Cover Gasket	1	27847 (Weatherproof Units Only)		35841 (Weatherproof Units Only)		
627-102	Back Frame Cover Gasket	1	27848 (Weatherproof Units Only)		35840 (Weatherproof Units Only)		
627-107	Motor Cover and Back Frame Cover Alignment Pin	8	-		983784		
627-108	Motor Housing Cover Screw	-	987397 (2 req'd)		87333 (4 req'd)		
627-109	Motor Housing Cover Screw Lockwasher	-	982226 for Non-Weatherproof Units, 982251 for Weatherproof Units - 2 req'd.		954803 for Non-Weatherproof Units, 982251 for Weatherproof units-4 req'd.		
627-110	Motor Housing Cover	1	¹ 27597 (includes 627-402 , 446 & 447)		36009		
627-111	Back Frame Dowel	2	-		35768		
627-112	Suspension Adapter Anchor	2	-		35066	36015	
627-113	Hoist Identification Plate	1	Contact CM				
627-114	Hoist I.D. Plate Drive Screw	2	988271				
627-115	Motor Housing	1	27028		35025	36014	
627-116	Loose End Nut	1	82638		82639		
627-117	Suspension Adapter Nut	2	927755		935791		
627-118	Chain Guide	2	27008		35018		
627-119	Gear Housing Plug	1	-		935767		
627-120	Gear Housing	1	27029		35620 (includes 627-119)	36604 (includes 627-119)	
627-122	Gear Housing	4	28830		35733		

	Attaching Screw			
627-123	Back Frame Expansion Plug	1	940837	-
627-124	Gear Housing Gasket	1	27747	35707
627-125	Back Frame	1	27618 (includes 627-123 & 627-211)	35031
627-127	Back Frame Attaching Screw	3	982699	-
627-128	Back Frame Attaching Screw	2	-	982698 (1-3/4" long)
627-129	Back Frame Attaching Screw	2	-	987322 (2" long)
627-130	Back Frame Cover	1	28009	36008 (Also order 627-445)
627-131	Back Frame Cover Screw Lockwasher	-	954803 for Non-Weatherproof Units 982251 for Weatherproof Units. 3 req'd for models A thru H-2, 4 req'd. for models J thru RRT-2	
627-132	Back Frame Cover Screw	-	87325 (3 req'd.)	968752 (4 req'd.)
627-302	Liftwheel	1	27360	35421
627-303	Liftwheel Gear	1	27010 (47 teeth) for models A, A-2, C & C-2, 27380 (39 teeth) for models AA & AA-2, 27009 (53 teeth) for models B, B-2, E, E-2, F, F-2, H & H-2, 35009 (79 teeth) for models J, J-2, L, L-2, R, R-2. RT & RT-2, 35639 (60 teeth) for models JJ, JJ-2, LL, LL-2, RR, RR-2 RRT & RRT-2.	
627-304	Liftwheel Gear Snap Ring	1	27767	-
627-305	Liftwheel Gear Nut	1	-	35773
627-306	Liftwheel Gear Nut Washer	1	-	986276
627-307	Liftwheel Bearing-Gear End	1	88429	82002
627-308	Liftwheel Bearing-Motor End	1	88429	83669
627-310	Drive Shaft and Pinion Sub-Assembly (Items 627-311 Thru 627-315, As Applicable)	1	27654 (shaft length = 5-43/64) for models AA, AA-2, C, C-2, F, F-2, H & H-2. 27653 (shaft length = 5-15/64) for models A, A-2, B, B-2, E & E-2. 35688 (18 T. pinion and 13 T. hub) for models J, J-2, JJ & JJ-2. 35687 (12 T. pinion and 13 T. hub) for models L, L-2, LL, LL-2, R, R-2, RR, RR-2, RT RT-2, RRT & RRT-2.	
627-311	Drive Shaft and Pinion	1	C204 for models AA, AA-2, C, C-2, F, F-2, H & H-2. C203 for Models A, A-2, B, B-2 E. E & E-2. 35357 (18 teeth) (or models J, J-2, JJ, & JJ-2. 35356 (12 teeth) for models L, L-2, LL LL-2 , R, R-2, RR, RR-2, RT, RT-2, RRT &	

			RRT-2.	
627-312	Drive Shaft and Pinion Bearing	1	82009	83691
627-313	Drive Shaft and Pinion Bearing Spacer	1	27710	-
627-314	Brake Hub	1	27852 (1-1/8 long) for models AA, AA-2, C, C-2, F, F-2, H & H-2. 27851 (21/32 long) for models A, A-2, B, B-2, E & E-2.	35744
627-315	Brake Hub Snap Ring	1	27766	35766
627-321	Intermediate Gear and Pinion Bearing-Outboard	1	82009	88437
627-322	Limit Switch Drive Pinion	1	27712	
627-323	Intermediate Gear Snap Ring	1	27765	35763
627-325	Intermediate Pinion (includes Item 627-322 (If Applicable))	1	28624 (14 teeth) for models, A, A-2, G & G-2. 28625 (22 teeth) for models AA & AA-2. 28623 (8 teeth) for models B, B-2, E, E-2, F, F-2, H & H-2. 35351 (10 teeth) for models J, J-2, L, L-2, R, R-2, RT & RT-2. 35420 (15 teeth) for models JJ, JJ-2, LL, LL-2, RR, RR-2, RRT & RRT-2.	
627-326	[Intermediate Gear and Pinion Bearing-Inboard	1	88440	Order (1) Bearing 83670 and (1) shaft adapter 24350
627-327	Lodestar Protector	1	28694 for models A, A-2 B, B-2, E & E-2. 28693 for models AA & AA-2, 28695 for models C, C-2, F, F-2, H & H-2. 36668 for models J & J-2. 36669 for models JJ & JJ-2. 36670 for models L, L-2, R, R-2, RT & RT-2. 36671 for models LL, LL-2, RR, RR-2, RRT & RRT-2.	
627-328	Lodestar Protector Kit (Includes items 627-124,627-321,627-322,627-323, 627-325 & 627-327 for models A, A-2, AA, AA-2, B, B-2, C, C-2, E, E-2, F, F-2, H & H-2. Includes Items 627-124,627-321,627-323,627-325 & 627-327 for models J, J-2, L, L-2, R, R-2, RT and RT-2. Includes items 627-124, 627-323 & 627-327 for models JJ, JJ-2, LL, LL-2,	-	2876 for models A & A-2, 2877 for models AA & AA-2. 2878 for models B, B-2, E & E-2.2879 for models C & C-2.2880 for models F, F-2, H & H-2. 3601 for models J & J-2. 3602 (or models JJ & JJ-2. 3603 for models L, L-2, R, R-2, RT & RT-2 3604 for models LL, LL-2, RR, RR-2, RRT & RRT-2.	

	RR, RR-2, RRT & RRT-2.						
627-401	Motor Shaft Bearing Retaining Nut	1	-	935770			
627-402	Motor Shaft Bearing-Outboard	1	82009	88437			
627-406	Bearing Retainer Screw	2	-	983613			
627-409	Bearing Retainer	1	-	35746			
627-410	Motor End Bell	1	-	35004			
627-411	Motor End Bell Attaching Screw	4	-	See separate parts list on page 36			
627-412	Motor End Bell Attaching Screw Lockwasher	4	-	982226			
627-413	Rotor and Shaft Sub-Assembly	1	See separate parts list on page 36				
627-414	Stator Pin	1	983541	-			
627-415	Stator	1	See separate parts list on page 36				
627-416	Motor Shaft Bearing - Inboard	1	82003	82004			
627-417	Motor Shaft Inboard Bearing Snap Ring	2	27790	35764			
627-446	Rotor Wave Washer	1	27292	-			
627-447	Rotor Bearing Spacer	1	27291	-			
627-700	Swivel Hook Suspension (includes Items 627-701 thru 627-706 for A, A-2, AA, AA-2, B, B-2, C, C-2, F, F-2, J, J-2, JJ, JJ-2, L, L-2, LL & LL-2. Includes items 627-701 thru 627-706, 627-830 & 627-833 thru 627-836 for models E, E-2, H, H-2, R, R-2, RR & RR-2. Includes Items 627-701,627-	1	² 2792 (latch type hook)	² 2793 (latch type hook)	² 3661 (latch type hook)	² 3660 (latch type hook)	² 9557 (latch type hook)

	702,627-703, 627-705 & 627-706 for models RT, RT-2, RRT & RRT-2)						
627-701	Upper Hook with Latch-Latch Type	1	28689	28697	35617	35616	36613
	Upper Hook-Latchlok Type	1	28643	28602	36678	36680	36694
627-702	Suspension Adapter Screw (Special Alloy Steel)	2	27529		35588		
627-703	Suspension Adapter	1	27703	27013	35740	35741	Order complete suspension
627-704	Upper Hook Washer-for Swivel Hook Suspension	1	27786	45930	45930	45918	
627-705	Upper Hook Collar/nut-for Swivel Hook Suspension	1	27350	27359	35042	35041	36352
627-706	Upper Hook or Suspension Lug Pin-Special Alloy Steel-Specify Whether for Swivel or Rigid Type Suspension	1	27805	45941	983763 rigid susp. 983764 for Swivel Susp.	983761 rigid susp. 983762 for Swivel Susp.	983762
627-710	Rigid Hook Suspension (includes items 627-701,627-702,627-703,627-706 & 627-711 for models A, A-2, AA, AA-2, B, B-2 C, C-2, F, F-2, J, J-2, JJ, JJ-2, L, L-2, LL & LL-2. Includes Items 627-701,627-702, 627-703, 627-706, 627-711, 627-830 and 627-833 thru 627-836 for models E, E-2, H, H-2, R, R-2, RR and RR-2. Includes item; 627-701, 627-702, 627-703, 627-705 and 627-706 for models RT, RT-2, RRT and RRT-2.	1	² 2788 (Latch type hook)	² 2789 (Latch type hook)	² 3651 (Latch type hook)	² 3658 (Latch type hook)	² 9559 (Latch type hook)
627-711	Upper Hook or Suspension Lug Collar (for Rigid	1	27361	27370	35458	35479	³ 36360

	Hook or Lug Suspension)						
627-716	Latch Kit (specify no. req'd.)	-	45661	45662	45662	45663	45663
627-720	Lug suspension includes items 627-702,627-703,627-706, 627-711 and 627-721 A for models A, A-2, AA, AA-2, B, B-2, C, C-2, F, F-2, J, J-2, JJ, JJ-2, L, L-2, LL and LL-2. Includes items 627-702, 627-703, 627-706 627-711, 627-721 A, 627-830 and 627-823 thru 627-836 for models E, E-2, H, H-2 R, R-2, RR and RR-2. Includes items 627-703, 627-706, 627-711, 627-728, 627-729 and 627-730 for models RT, RT-2, RRT and RRT-2.	1	2778 for series 635 low headroom trolley	2779 for series 635 low headroom trolley	3677 for series 635 low headroom trolley	3668	9561
			2992 for series 635 motor driven trolley	2993 for series 635 motor driven trolley	3679 for series 635 motor driven trolley		
627-721 A	Suspension lug: for series 635 low headroom trolley	1	27450	27452	35456	35457	-
	for series 635 motor driven trolley.	1	27454	27455	35459	35457	-
627-721 B	Suspension lug-special, high strength bolts-grade 6 or stronger are required for attachment	1	Contact CM				-
627-722	Hook Block screws with nuts and lockwashers (2 ea.)	1					C245
627-723	Cloverleaf plate with attaching screws	1					C246
627-724	Sheave stud with washer, slotted nut, seat and retainer pin	1					C247
627-725	Sheave Hanger	1					36011
627-726	Sheave Hanger	2					88429

	Bearing						
627-727	Upper Sheave	1		-			36350
627-728	Suspension Lug	1		-			Order complete suspension
627-729	Shackle with Pin and Retainer Rings	1		-			
627-730	Suspension Lug Pin with Retainer Pins	1		-			C248
627-731	Bearing Retainer Ring	1		-			40740
627-732	Dead End Screw with Nut and Lockwasher	1		-			C249
627-740	Loose End Screw	1	927764			987210	
627-741	Loose End Screw Lockwasher	1	954803			945851	
627-742	Loose End Screw Washer	1	954802			954807	
627-743	Loose End Link	1	27351			35367	
627-750	Load Chain - Specify Length Req'd.	1	85944			85949	
627-760	Lower Hook and Block Assembly	1	⁴ 28683	-	⁴ C206		-
627-763	Lower Hook Body	1	45401	-	35370		-
627-764	Lower Hook Chain Block Pin	1	45943	-	35790		-
627-770	Lower Hook Assembly	1	-	⁵ 28665	-	⁵ 35645	⁵ 36606
627-771	Lower Hook with Latch: Latch Type Hook	1	28686	28687	35611	35612	36606
	Latchlok Type Hook	-	28604	28603	28604	36681	⁶
627-772	Lower Hook Thrust Bearing	1	88485	88478	88485	88505	88505
627-773	Lower Hook Collar	1	-	27359	-	35478	-
627-774	Lower Hook Pin	1	983772	45941	983772	45946	983762
627-775	Lower Hook Chain	1	28007	-	35026	-	-

	Block						
627-776	Lower Hook Nut	1	982526	-	982526	-	36352
627-777	Lower Hook Block Washer	1	945921	-	945921	-	-
627-830	Dead End Bolt (special alloy)	1	-	89508	-	35957	-
627-833	Dead End Block	1	-	27397	-	35418	-
627-834	Dead End Pin (special alloy)	1	-	82320	-	82314	-
627-835	Dead End Pin Cotter Pin	1	-	988330	-	988330	-
627-836	Dead End Pin Washer	1		987878		987877	
627-837	Contact Block	1				36764	
627-860	Lower Hook Block Assembly-complete	1		⁷ 28685		⁷ 35621	⁸ 36607
627-861	Hook Block Sheave	1		27017		35010	36351
627-862	Hook Block Sheave Bearing	2	-	88429	-	83674	83670
627-863	Hook Block (order in pairs)	2	-	27048	-	35034	36010
627-864	Hook Block Screw-Long	2		982066		982374	
627-865	Hook Block Screw-Short	1	-	986191	-	982370	-
627-866	Hook Block Screw L.W.	3		940802		940830	
627-867	Hook Block Screw Nut	3	-	982514	-	982445	-

¹ Also order capacity/warning label 627-445.

² Contact CM for part number of suspension with latchlok type hook.

³ For swivel hook nut, part number is 36352.

⁴ Latch type hook. Contact CM for part number of lower hook and body with latchlok type hook.

⁵ Latch type hook. Contact CM for part number of lower hook assembly with latchlok type hook.

⁶ Contact CM for part number of latchlok type hook.

⁷ With latch type hook. If lower hook block assembly with latchlok type hook is required, contact CM.

⁸ 627-732 not included and must be ordered separately.

**Part Numbers for Brake Coils, Brake Assemblies,
Rotors, Stators and Motor End Bell Attaching Screws**

Key No.	Part Name	Models and Voltages									
		A, B and E			AA, C, F and H			A-2, B-2 and E-2		AA-2, C-2, F-2 & H-2	
		115-1-60	230-1-60	230/460	115-1-60	230-1-60	230/460	230	460	230	460
627-250	Electric Brake Assembly-complete	27656	27659	27659	27681	27684	27684	27659	28655	27684	28656
627-259	Brake Coil	51517	51518	51518	51517	51518	51518	51518	51519	51518	51519
627-413	* Rotor and Shaft Assembly	27516	27514	27516	27527	27515	27517	27518	27519	27519	27519
627-415	* Stator	28740	28771	28742	28739	28772	28741	28815	28818	28817	28818

**Part Numbers for Brake Coils, Brake Assemblies,
Rotors, Stators and Motor End Bell Attaching Screws**

Key No.	Part Name	Models and Voltages							
		J, L, R and RT			JJ, LL, RR and RRT	J-2, L-2, R-2 and RT-2		JJ-2, LL-2, RR-2 and RRT-2	
		115-1-60	230-1-60	230/460	230/460	230	460	230	460
627-250	Electric Brake Assembly Complete	35646	35647	35647	35648	35647	35622	35648	35623
627-259	Brake Coil	51510	51511	51511	51512	51511	51513	51512	51514
627-411	Motor End Bell Attaching Screw	87334-7.9" LG.	87334-7.9" LG.	87377-7.4" LG.	87336-8.4" LG.	87334-7.9" LG.	87334-7.9" LG.	87336 8.4" LG.	87336 8.4" LG.
627-413	'Rotor and Shaft Assembly	36691	35609	35604	36689	35618	35618	36690	36690
627-415	'Stator	36712	36235	35714	35715	A36715	36717	B36720	36722

*Rotors and Stators must be ordered in pairs.

A-For 220-3-50 power supply part number is 36716.

B-For 220-3-50 power supply part number is 36721.

NOTE: Except as indicated above, Electric Brake Assemblies, Brake Coils, Rotor Assemblies and Stators listed under "230/460" are also suitable for operation on 220/380-3-50 or 220/415-3-50. Those listed under "230" are also suitable for operation on 220-3-50 and those listed under "460" are also suitable for operation on 380-3-50 or 415-3-50.

**Part Number for Packaged Lubricants
Used in the Lodestar Electric Chain Hoists
(Refer to page 15 for Lubrication Instructions)**

Lubricant Usage	Type of Lubricant	Part Numbers and Packaged Quantity of Lubricants
Hoist Gears	Grease (Special)	28605 for 1/2 #Can 28616 for 1# Can 28617 for 4# Can
Spline on end of Drive Shafts	Oil-Graphite Mixture	40628 for 1 Pint Can
Load Chain	Oil	28608 for 1 Pint Can 28619 for 1 Gal. Can
Limit Switch Shaft Threads	*Oil	"3 in 1" or Light Machine Oil-obtain locally
Lower Hook Thrust Bearing	*Oil	Heavy Machine Oil-obtain locally

* These oils are not furnished by CM in Packaged Quantities.

When ordering lubricants, specify the type of lubricant, part number and packaged quantity required.

Touch-up Paints for Lodestar Electric Chain Hoists and Series 635 Low Headroom Trolleys:

1. Hoist. Order '(1) case (12-12oz. Aerosol Cans) of Orange Touch-up paint Part Number 84190.

2. Trolley. Order '(1) case (12-12 oz. Aerosol Cans) of Black Touch-up paint Part Number 84189.

*Touch-up paints are only available in case quantities.

NOTE: When painting Hoists or Trolleys, also order warning labels, identification labels, etc. that may be coated during painting.